



LKS INDUSTRIES



MANUFACTURER OF INDUSTRIAL STRAINERS AND VALVES





Office :

**No.25/C,Parvathy Sankaran Premises,
Sankar Sealing Road,Ayanambakkam,
Chennai - 600095.**

Contact details :

+91 8072051319

+91 9176677207

sales.lksindustries@gmail.com

lksindustriesnew@gmail.com

Web page :

www.lksindustries.com

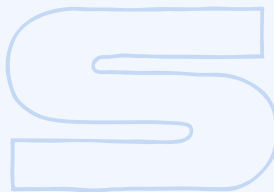



Introduction

We would like to take this opportunity to introduce our company **LKS Industries** : a complete manufacturer of **strainers, valves, suction diffusers** and special equipments that is been supplying its products to Petrochemical , Chemical , Power , Oil&Gas , Water Treatment and Onshore / Offshore industries worldwide since its establishment in 2008.

Over the years LKS Industries has developed an extensive range of pipeline ancillaries, Conical , Y and Tee type Strainers , Bucket strainers , Valves , Suction diffusers and thanks to our special engineering division, strainers for special applications.

All items can be supplied in carbon steel and stainless steel and in most cases they are available in very short delivery times directly from our stock. Customized materials are also available on request. Manufacturing execution can be forged, cast or welded fabricated depending on the type and size. LKS Industries can supply strainers from ½” to 82” for ratings up to 4500 lbs.



LKS Industries is a flexible and constantly developing company. Within our technical department part of the staff is dedicated to research and development, to enable our company to implement improvements or brand new products on a regular basis.

LKS Industries quality, environment and safety systems are certified according to ISO 9001, ISO 14001. Our quality assurance department is an independent body, ensuring that our quality assurance, environment and safety procedures are respected and implemented throughout the entire cycle of the manufacturing process.

We hope that you find our range of products interesting. Should you require any further detail or additional information concerning LKS Industries, please do not hesitate to visit our website..... and to contact us at our premises, where we are at your complete disposal.

WWW.LKS INDUSTRIES.COM

APPLICATIONS : EVERYWHERE

STEEL INDUSTRIES



WATER TREATMENT



PHARMA & DRUGS



POWER GENERATION



FERTILIZER PLANTS



CEMENT & CHEMICAL INDUSTRIES



REFINERY / PETRO CHEMICALS



PULP, PAPER & SUGAR



OEM & CONTRACTORS

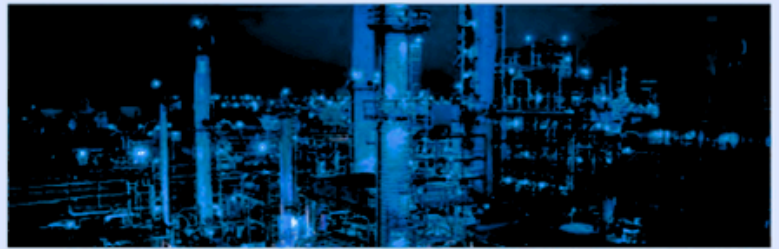
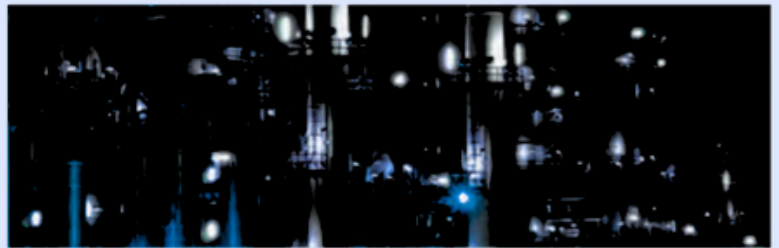

CERTIFICATIONS



Y - STRAINER

Y-Strainers are devices for mechanically removing unwanted solids from liquid, gas or steam lines by means of a perforated or wire mesh straining element. They are used in pipelines to protect pumps, meters, control valves, steam traps, regulators and other process equipment.

Y Type Strainers can be used in horizontal or vertical (downward) pipelines. A cylindrical perforated or mesh-lined screen within the strainer collects debris as the flow travels through the strainer.

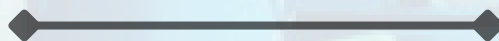



LARGE VARIETY
OF Y- STRAINERS

CASTED FLANGED Y STRAINERS

YLK Series

Design Features

- ▶ ANSI B16.5 Available as standard. IS, DIN, BS 10 connections on request
- ▶ Strainer body meets ASME B16.34.
- ▶ Bolted covers to ANSI 16.5 is Standard
- ▶ CAF, Neoprene, NACE, TEFLON gaskets can be provide
- ▶ Machined filter guides on cover and body is standard



- ▶ Drain/Blow-off connection furnished with plug as standard.
- ▶ Minimum of 4 times free straining area .to pipe cross sectional area along with properly
- ▶ Proportioned body geometry ensures low pressure drop and low cleaning cycle
- ▶ Guaranteed pressure drop as per curves shown in Table -4b.
- ▶ Pressure rating- 150, 300 lbs

Dimensions

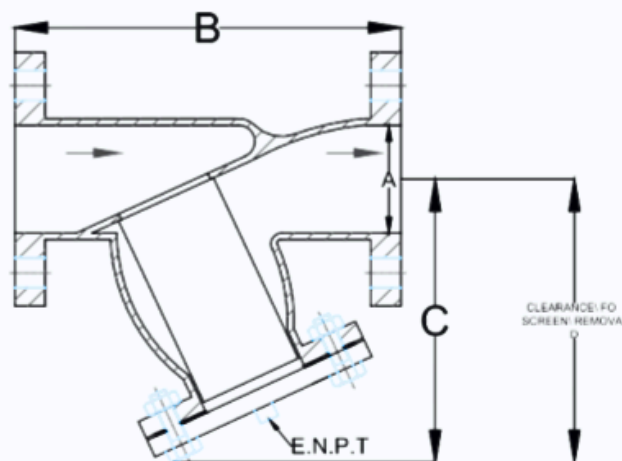

Material Data

COMPONENT	MATERIAL
Body	216 WCB, ICB, CF8, CF8M, Cast Iron (only in 150lbs)
Cover	Carbonsteel, Stainless Steel
Fastener	A193 B7 Bolts & A 194 2 H Nuts With spring washer
Gasket	CAF, NACF, Neoprene, Nitrile, PTFE
Drain/Vent Plug	A105, CS TO IS 1875-II, Stainless Steel
Filter Element	SS 304, 316, Duplex, Brass, Monel, Hastalloy C

Size	A(mm)		B(mm)		C(mm)		D(mm)		E NPT(mm)	
	150	300	150	300	150	300	150	300	150	300
15	13	13	152	165	99	108	121	146	8	8
20	19	19	178	197	108	127	146	171	10	10
25	25	25	191	200	121	140	162	206	15	15
40	38	38	229	267	143	178	229	260	15	15
50	51	51	219	236	133	145	191	203	15	15
65	64	64	260	276	191	183	267	260	20	20
80	76	76	295	320	195	207	276	292	25	25
100	102	102	365	372	232	245	330	346	40	40'
125	127	127	448	470	279	391	432	546	50	50
150	152	152	473	502	330	381	467	546	50	50
200	203	203	619	635	389	419	549	559	50	50
250	254	254	660	705	486	538	686	762	50	50
300	305	305	772	838	559	617	787	873	50	50

Standard Screens

SIZE RANGE	OPENING
1/2"-1-1/2" (15mm-40mm)	0.032 in. (0.8mm)
2"-3" (50mm-80mm)	0.045 in. (1.2mm)
4" & Larger (100mm & Larger)	0.125 in. (3.2mm)



No.25/C, Parvathi Sankaran Premises,
Shankar sealing road, Ayanambakkam,
Chennai 600095



sales.lksindustries@gmail.com

L K S



+91 8072051319
+91 91766 77207



www.lksindustries.com

CASTED FLANGED Y STRAINERS

YFC Series

Design Features

- ▶ Standard sizes from 2" - 24".
- ▶ BS 10 Tab E Flanged end connection
- ▶ Hydro tested to 15 bar
- ▶ Bolted covers to BS 10 Tab "E"
- ▶ May be installed in horizontal or vertical pipelines.
- ▶ Qualified welders as per ASME SEC VIII.DP of welds are standard
- ▶ Dummy cover flange
- ▶ Ideal for commercial installations where higher pressure drop can be allowed



- ▶ Weld mesh Backed filter elements with 40 mesh lining.
- ▶ Net free straining area , 2 times pipe c/s area min.
- ▶ Class A ERW pipe body (For Standard screens and 40 mesh lined screens using least restrictive method)

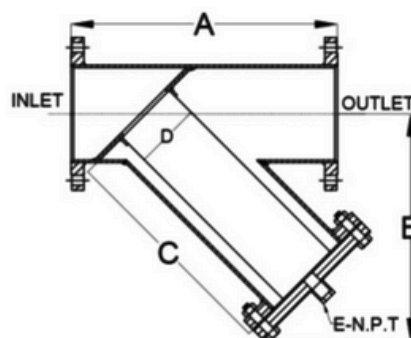

Dimensions

Size	A	B	C	D	E
40	245	111	82	30	1/2"
50	270	128	96	40	1/2"
65	290	148	117	55	3/4"
80	310	172	140	70	3/4"
100	380	220	191	80	3/4"
125	355	269	239	100	3/4"
150	470	306	275	125	3/4"
200	600	403	382	160	1"
250	750	480	454	210	1"
300	900	554	529	260	1"
350	1000	633	603	310	1"
400	1100	687	651	375	1-1/2"
450	1250	778	745	415	1-1/2"
500	1150	845	804	475	1-1/2"
600	1500	1052	1027	535	1-1/2"
700	1670	1289	1360	550	1-1/2"
800	1800	1428	1503	650	1-1/2"

Material Data

COMPONENT	MATERIALS
Body	IS1239/3589
Cover	CS TO IS 2062
Fastener	CS TO IS 1367
Gaskets	CAF, Neoprene, Nitrile
Drain / Vent Plug	CS TO IS 1875-II
Filter Element	SS 304,316

Standard Screens

SIZE RANGE	OPENING
2"50mm-4"100mm	4mm sq weld mesh lined with 40 mesh
5"125mm -12"300mm	10mm sq weld mesh lined with 40 mesh

CASTED FLANGED Y STRAINERS

YLFF Series

Design Features

- ▶ ANSI B16.5 150 lbs SORF
- ▶ ANSI B16.5 150 lbs SORF
- ▶ Bolted cover with VENT PLUG Is Standard
- ▶ Neoprene gaskets
- ▶ Machined filter guides on body is standard
- ▶ Minimum of 2.5 times free straining area .to pipe cross sectional

- ▶ No guaranteed pressure drop. Model used for commercial application where higher pressure drop is permissible
- ▶ Pressure rating 150 lbs

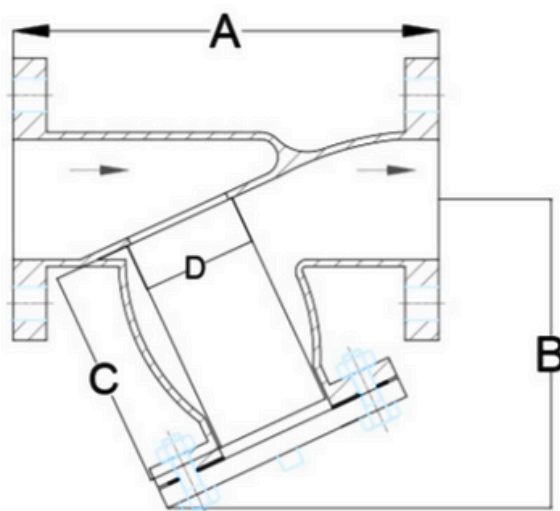

Material Data

COMPONENT	MATERIAL
Body	Cast Iron TO IS210
Cover	CAST IRON
Fastener	CS TO IS 1367.
Gasket	Nitrile rubber / NEOPRENE /CAF
Filter Element	SS 304,

* Other materials available on request.

Dimensions

Size	A	B	C	D
25	127	123	105	25
40	165	170	161	40
50	203	196	185	50
65	216	216	200	65
80	241	229	213	80
100	292	282	267	100
125	355	349	350	125
150	382	383	385	150
200	441	425	402	200

Standard Screens

SIZE RANGE	OPENING
40NB TO 300NB	2mm to 3mm

CASTED FLANGED Y STRAINERS

YSS Series

Design Features

- ▶ Sizes 15nb to 40 nb
- ▶ Strainers are available with threaded or socket weld inlet/outlet connections.
- ▶ Strainer are designed to relevant ASME standards
- ▶ Body investment casted and well proportioned to ensure low pressure drop as per annexure 2
- ▶ Guaranteed pressure drop as per table - 4a.
- ▶ Net free straining area is min. 4 times pipe cross sectional area with standard screens
- ▶ Machined filter seats on both ends for precise seating of filter element
- ▶ Grooved , Threaded end cover which doubles up as drain/blow off
- ▶ Threaded covers are provided with flat gaskets for proper sealing
- ▶ Pressure rating 25 bar

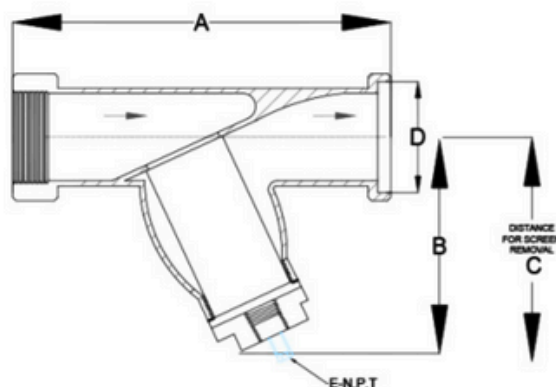

Material Data

COMPONENT	MATERIALS
Body / Cover	216 WCB, ICB, CF8, CF8M, GM, Ni Al Bronze
Gaskets	CAF, NACF, Neoprene, Nitrile, PTFE
Filter Element	SS 304, 316, Duplex, Brass, Monel, Hastalloy C

Dimensions

Size	A	B	C	D	E
15	59	40	60	21.72	10
20	80	54	81	27.05	10
25	84	67	102	33.78	15
32	105	76	114	42.55	15
40	119	81	121	48.64	15
50	138	97	146	61.11	15
65	183	124	184	73.81	15
80	203	133	190	89.79	15

Standard Screens

SIZE RANGE	OPENING
½ in-1½ in (15mm-40mm)	0.039 in (1 mm)



TEE - STRAINER

Tee - strainer is also known as Bathtub strainer, they are used as fixed strainers in large bore lines of 2" and above.

They may be flanged or welded to the pipe network on which they are mounted.

Tee strainers is a custom-made compound strainer intended to extract foreign contaminants from the pipeline. Tee

Style Strainers are a low-cost option for high nominal bore straining specifications.

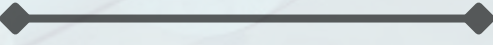



HIGH QUALITY
TEE - STRAINERS

FABRICATED T STRAINERS

A Series

Design Features

- ▶ Standard sizes from 2" - 24". Larger sizes available upon request.
- ▶ Available with RF flanged ANSI B16.5 or Butt welded ends
- ▶ Standard thru bolt cover design
- ▶ 304 SS perforated screens are standard.
- ▶ May be installed in horizontal or vertical pipelines.
- ▶ All welders are qualified to ASME Section IX.
- ▶ Strainers designed to meet the requirements of ASME B31.1, ASME B31.3 and / or ASME Section VIII, Div. I.
- ▶ Drains, vents, differentials and special covers are optional.
- ▶ Pressure drop as per Table-2
- ▶ End and cover flanges can be supplied as Slip on



Dimensions

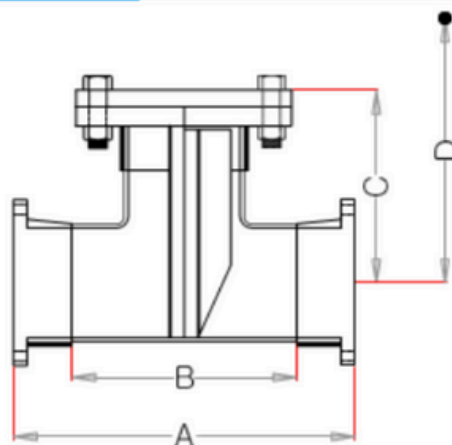

Material Data

COMPONENT	MATERIAL
Body	A234 Gr WPB/ CS TO IS1239/3589 / ASTM A106/SS304/ SS316
Cover	CS TO IS 2062, ASTM A105, SA516, Gr60/70, SS304, SS316
Connection Flanges	CS TO IS 2062, ASTM A105, SA516, Gr60/70, SS304, SS316
Fastener	A193 Gr B7, CS TO IS 1367, Stainless steel
Gasket	CAF, NACF, Neoprene, Nitrile, PTFE

Size	A	B	C	D
50	254	127	146	279
80	311	172	179	349
100	362	210	205	413
125	425	248	237	489
150	464	286	257	540
200	559	356	305	660
250	635	432	348	762
300	737	508	400	889
350	813	559	441	991
400	864	610	468	1067
450	965	686	522	1194
500	1051	762	568	1305
600	1168	864	632	1473

Standard Screens

SIZE RANGE	OPENING
2"-8"(50mm-200mm)	0.125 IN. (3.2mm)
10"-12" (250mm-300mm)	0.125 IN. (3.2mm)
14"-24" (350mm-600mm)	0.188 IN. (4.8mm)



No.25/C,Parvathi Sankaran Premises,
Shankar sealing road, Ayanambakkam ,
Chennai 600095



sales.lksindustries@gmail.com

L K S



+91 8072051319
+91 91766 77207



www.lksindustries.com

BASKET STRAINER

Basket Strainers features top removal of the screen. The screen is in the form of a basket, with a lifting handle, so that all particulate captured and retained by the screen can be easily removed for disposal. They are intended for applications where large amounts of solids particulate are expected and where the clean-out will be frequent LKS Basket Strainers can be equipped with Bolted Covers, Hinged Covers, Clamped Covers, a Davit Lifting Device or other Lifting Device to make removal of large heavy covers safe and efficient. Widespread list of options is available. Basket Strainers is in stock at LKS ensuring prompt delivery of your order.

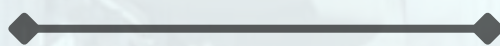



BASKET STRAINERS

FABRICATED BASKET STRAINERS

BFFL Series

Design Features

- ▶ Standard sizes from 2" – 24". Larger sizes available upon request
- ▶ Flanged to BS 10 TAB 'E' or Butt-weld end connections
- ▶ Standard thru bolt cover design
- ▶ 3mm Perforated screens are standard
- ▶ May be installed in horizontal pipelines
- ▶ Drain/ vent with plug is standard
- ▶ Net free straining area minimum 4 times for standard screens
- ▶ Hydro tested to 12 bar
- ▶ Qualified welders as per ASME SEC VIII.DP ie welds are standard
- ▶ Covers are made of Flanged to bs 10 tab "E" with Drain plug
- ▶ Differential pressure ports with plug is Standard
- ▶ Post Box red , high temperature resistant paint
- ▶ Heat resistant gaskets are standard
- ▶ Fasteners with spring washer is standard to provide for thermal expansion
- ▶ Class A ERW pipe bod

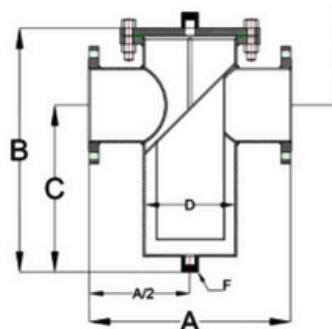

Dimensions

Size	A	B	C	D	E
25	175	277	177	33	215
40	218	325	213	48	275
50	264	361	232	60	320
65	267	439.5	302.5	76	395
80	315	510.5	348.5	89	463
100	349	611	418	114	575
150	406	982	797	165	872
200	536	1126	904	219	1036
250	609	1304	1044	273	1214
300	678	1503	1199	324	1403
350	760	1669	1337	356	1579
400	799	1996	1561	406	1831
500	908	2274	1818	508	2152
600	1000	2854.5	2354.5	600	2698
700	1100	3174	2574	700	3094
750	1100	3413	2763	750	3292
900	1575	4080	3242	900	3930
1000	1800	4401	3456	1000	4338
1100	1955	4836	3791	1100	4740

Material Data

COMPONENT	MATERIALS
Body	CS TO IS1239,3589 Class A / CS TO IS 2062
Cover	CS TO IS 2062
Fastener	CS TO IS 1367 Gr 4.6 with spring washer
Gaskets	Heat Resistant Gaskets
Drain / Vent Plug	A105, CS TO IS 1875-II
Filter Element	SS 202

Standard Screens

SIZE RANGE	OPENING
2"-8"(50mm-200mm)	0.125 IN.(3.2mm)

FABRICATED BASKET STRAINERS

BFP Series

Design Features

- ▶ Standard sizes from 2" - 24". Larger sizes available upon request
- ▶ Available In flanged or Butt-weld end connections
- ▶ Standard thru bolt cover design. Other covers on request
- ▶ Designed to API 6D & Face to Face as per ASME B16.10
- ▶ Perforated screens are standard
- ▶ May be installed in horizontal pipelines
- ▶ All welders are qualified to ASME Section IX.
- ▶ Strainers designed to meet the requirements of ASME Section VIII, Div.1.
- ▶ Drain with plug is standard . Drain valves can be supplied on request
- ▶ Vents with plug and Dp indicators are standard
- ▶ Large body with Guaranteed low pressure drop as per pressure drop curves in Table -3
- ▶ Net free straining area minimum 6 times for standard screen

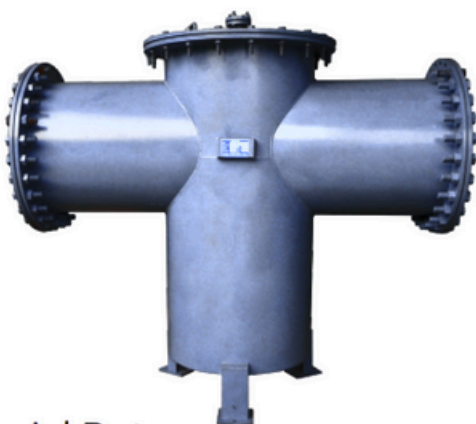

Dimensions

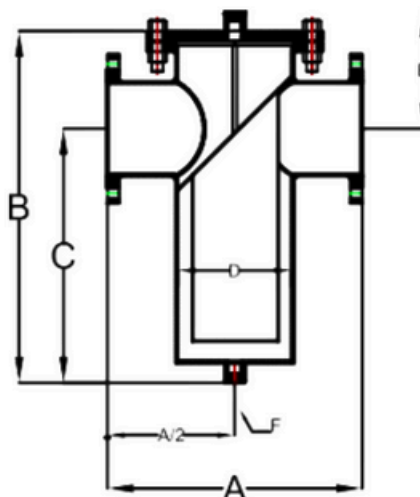

Material Data

COMPONENT	MATERIAL
Body	IS1239,3589 ASTM A106, SS304/316, DUPLEX STEEL
Cover	A105, SA 516 GR 70, CS TO IS 2062, SS316,304, DUPLEX STEEL
Fastener	A193 B7 Bolts & A 194 2 H Nuts With spring washer. SS 304/316
Gasket	CAF, NACF, Neoprene, Nitrile, PTFE
Drain/Vent Plug	A105, CS TO IS 1875-II, Stainless Steel
Filter Element	SS 304,316, Duplex, Brass, Monel, Hastalloy C

Standard Screens

SIZE RANGE	OPENING
2"-8" (50mm-200mm)	3mm
10"-12" (250mm-300mm)	3mm
14"-24" (350mm-600mm)	3mm

Size	A	B	C	D	E	F
50	324	473	283	168	635	15
80	356	521	318	219	724	20
100	406	565	356	219	775	25
125	457	616	432	273	775	25
150	508	858	617	273	914	25
200	559	1136	856	324	1092	40
250	813	1369	950	406	1473	40
300	889	1610	1184	457	1562	40
350	940	1822	1422	508	1772	50
400	1067	1980	1516	610	1930	50
450	1181	2413	1905	610	2363	50
500	1321	2407	1850	762	2359	50
600	1626	3022	2317	914	2972	50

FABRICATED BASKET STRAINERS

BFS Series

Design Features

- ▶ Standard sizes from 2" – 24". Larger sizes available upon request
- ▶ Available In flanged or Butt-weld end connections. ANSI B16.5, DIN, IS Flanges are available
- ▶ Standard thru bolt cover design. Other covers on request
- ▶ Perforated screens are standard
- ▶ May be installed in horizontal pipelines
- ▶ All welders are qualified to ASME Section IX
- ▶ Lined mesh screens on request
- ▶ Strainers designed to meet the requirements of ASME Section VIII, Div.1
- ▶ Drain/ vent with plug is standard . Drain valves can be supplied on request
- ▶ Dp indicators and vent/drain valves are optional
- ▶ Body diameter 1 size higher than the line size
- ▶ Medium pressure drop . Minimal Loss of energy
- ▶ Net free straining area minimum 6 times of pipe c/s area using least restrictive element for 40 mesh with perforated sheet backup element

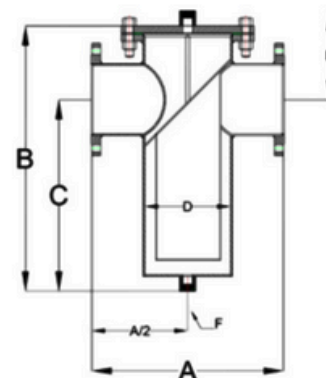

Dimensions

Material Data

COMPONENT	MATERIALS
Body	IS1239,3589 ASTM A106, SS304/316, DUPLEX STEEL
Cover	A105, SA 516 GR 70, CS TO IS 2062, SS316,304, DUPLEX STEEL
Fastener	CS TO IS 1367,. SS 304/316
Gaskets	CAF, Neoprene, Nitrile,PTFE
Drain / Vent Plug	A105, CS TO IS 1875-II, Stainless Steel
Filter Element	SS 304,316, Duplex, Brass, Monel, Hastalloy C

Size	A	B	C	D	E
25	190	265	165	48	215
40	230	345	233	60	295
50	280	399	270	76	358
65	280	479.5	342.5	89	435
80	340	575.5	413.5	114	528
100	400	687	494	165	651
150	460	982	797	219	872
200	590	1228	1006	273	1138
250	660	1495	1235	324	1405
300	710	1778	1474	356	1678
350	810	2025	1693	406	1935
400	850	2432	1997	457	2267
500	1000	2868	2412	600	2746
600	1100	3404.5	2904.5	700	3248
700	1200	3886	3286	800	3806
750	1250	4207	3556	900	4085
900	1675	5110	4272	1000	4960
1000	1900	5588	4643	1100	5525
1100	2055	6179	5134	1200	6083

Standard Screens

SIZE RANGE	OPENING
2"-8" (50mm-200mm)	3mm
10"-12" (250mm-300mm)	3mm
14"-24" (350mm-600mm)	3mm

FABRICATED BASKET STRAINERS

BEE Series

Design Features

- ▶ Standard sizes from 2" – 24". Larger sizes available upon request
- ▶ Available In flanged or Butter-Weld end connctions. ANSI B16.5 , DIN,IS Flanges are avabile
- ▶ Standard thru bolt cover design.Other Covers on request
- ▶ Perforated screens are standard
- ▶ May be installed in horizontal pipelines.
- ▶ All welders are qualified to ASME Section IX
- ▶ Straineres designed to meet the requirements of ASME Section VIII, Div.1
- ▶ Drain/ vent with plug is is standard . Draiv valves can be supplied on request
- ▶ Method used to reduce downtime. However for maximum efficiency the filter should be removed and cleaned
- ▶ DP indicators and vent/Blow off valves are optional
- ▶ Body diameter 1 size higher than the line size
- ▶ Medium Pressure drop. Minimal Loss of energy
- ▶ Net free straining area minimum 4 times for standard screens
- ▶ The blow off valve CAN BE PROVIDED AS AN OPTION when the filter chokes the blow off valve is opened and since the blow off valve is opened to atmosphere, flow reverses there by flushing out debris stuck to the filter. This reduces maintenance effort



Material Data

COMPONENT	MATERIALS
Body	CS to IS1239,3589 Class ASTM A106, SS304/316, DUPLEX STEEL
Cover	A105,SA 516 GR 70, CS TO IS 2062, SS316,304, DUPLEX STEEL
Fastener	CS TO IS 1367,.SS 304/316
Gaskets	CAF,Neoprene, Nitrile, PTFE
Drain / Vent Plug	A105, CS TO IS 1875-II, Stainless Steel
Filter Element	SS 304,316, Duplex, Brass. Monel, Hastalloy C

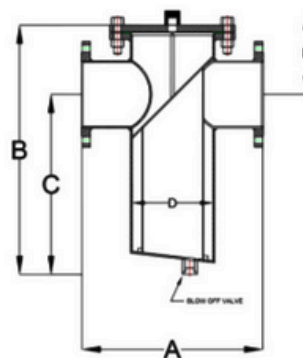

Dimensions

Size	A	B	C	D	E
50	324	473	283	168	635
80	356	521	318	219	724
100	406	565	356	219	775
125	457	616	432	273	775
150	508	673	432	273	914
200	559	813	533	324	1092
250	813	1054	635	406	1473
300	889	1137	711	457	1562
350	940	1238	838	508	1638
400	1067	1378	914	610	1842
450	1181	1524	1016	610	2032
500	1321	1727	1168	762	2286
600	1626	2102	1397	914	2807

Standard Screens

SIZE RANGE	OPENING
2"-8"(50MM-200MM)	0.118 IN. (3MM)
10"-12"(250mm-300mm)	0.118 IN. (3mm)
14"-24"(250mm-600mm)	0.177 in. (4.5mm)

CAST STEEL BASKET STRAINERS

BCP Series

Design Features

- ▶ Standard sizes from ½" – 1½" – screwed, 2"–8" – Flanged
- ▶ Available In Screwed and Flanged ANSI B16.5 150 LBS SORF Only
- ▶ Standard thru bolt cover design. Other covers on request
- ▶ Standard thru bolt cover design with ANSI B16.5 150 # Rating
- ▶ Perforated screens are standard
- ▶ May be installed in horizontal pipelines
- ▶ Castings can be radiographed on request
- ▶ Drain/Vent with plug is standard. Drain/Vent valves can be supplied on request
- ▶ Large body with Guaranteed low pressure drop (Table 3)
- ▶ Net free straining area minimum 6 times of pipe c/s area for standard screen
- ▶ Hinged Covers on request
- ▶ Drain/Vent valve on request
- ▶ Dp Indicators/ DP switch on request
- ▶ Mesh Lined Screens on request
- ▶ Pressure rating 15 bar



Dimensions

Material Data

COMPONENT	MATERIAL
Body	ASTM A216 WCB, CF8, CF8M, Ni Al Bronze, Cast Iron
Cover	A105, SA 516 GR 70, CS TO IS 2062, SS316,304
Fastener	A193 B7 Bolts & A 194 2 H Nuts with spring washer SS 304/316
Gasket	CAF, NACF, Neoprene, Nitrile, PTFE, Spiral wound gaskets
Drain/Vent Plug	A105, CS TO IS 1875-II, Stainless Steel
Filter Element	SS 304,316, Duplex, Brass, Monel, Hastalloy C

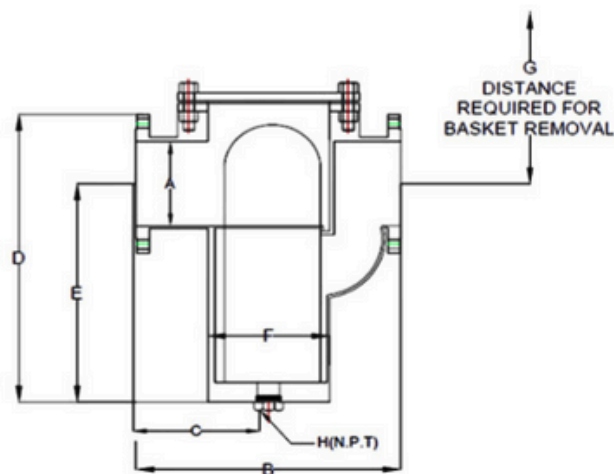

Size	A	B	C	D	E	F	G
40	38	241	121	254	165	111	343
50	51	267	133	295	194	124	397
80	76	333	167	386	270	152	502
100	102	438	213	400	273	187	527
150	152	498	222	629	467	298	791
200	203	686	330	879	686	352	1073

Standard Screens

SIZE RANGE	OPENING
15mm - 25mm	2mm
40mm - 80mm	3mm
100mm - 200mm	3mm

FABRICATED BASKET STRAINERS

BFE Series

Design Features

- ▶ Standard sizes from 2" – 24". Larger sizes available upon request
- ▶ Available In flanged to BS 10 TAB 'E' or Butt-weld end connections
- ▶ Standard thru bolt cover design
- ▶ Perforated screens are standard
- ▶ May be installed in horizontal pipelines
- ▶ Drain/ vent with plug is standard
- ▶ Body diameter 1 size higher than the line size
- ▶ Commercial strainer where higher pressure drop is allowable
- ▶ Net free straining area minimum 4 times for standard screens
- ▶ Hydro tested to 12 bar

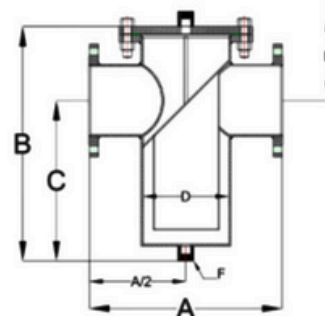

Dimensions

Size	A	B	C	D	E
25	175	259	159	33	227
40	218	222	110	48	28
50	264	314	185	60	326
65	267	392	255	76	417
80	315	440	278	89	493
100	349	451	258	114	616
150	406	685	500	165	917
200	536	598	376	219	1111
250	609	578	318	273	1111
300	678	594	290	324	1516
350	760	744	412	356	1409
400	799	929	494	406	1650
500	908	912	456	508	1923
600	1000	1272	772	600	2433
700	1100	1328	728	700	2779
750	1100	1456	806	750	2966
900	1575	2284	1446	900	3592
1000	1800	2185	1240	1000	3819
1100	1955	2271	1226	1100	4230

Material Data

COMPONENT	MATERIALS
Body	CS to IS1239,3589 Class A / CS TO IS 2062
Cover	CS TO IS 2062
Fastener	CS TO IS 1367
Gaskets	CAF, Neoprene, Nitrile
Drain / Vent Plug	A105, CS TO IS 1875-II, Stainless Steel
Filter Element	SS 304,316

Standard Screens

SIZE RANGE	OPENING
2"-8" (50mm-200mm)	0.125 IN. (3.2mm)
10"-12" (250mm-300mm)	0.125 IN. (3.2mm)
14"-24" (350mm-600mm)	0.188 in. (4.8mm)

CONICAL STRAINER

Conical Strainers are known as Temporary Strainers, and these Conical

Filter Strainers are used for the filtration of the system. We are suppliers

of Cone type temporary strainers in fully various designs. The Conical Temporary Strainers are mostly used for testing purposes by new plants.

Conical Strainers are very cost-effective straining solutions in many applications. Where the amount of material to be removed from the flow is relatively small, resulting in long intervals between screen cleanings, the strainer screen is manually cleaned by shutting down the line and removing the strainer cap.

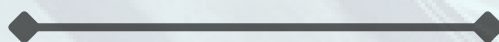

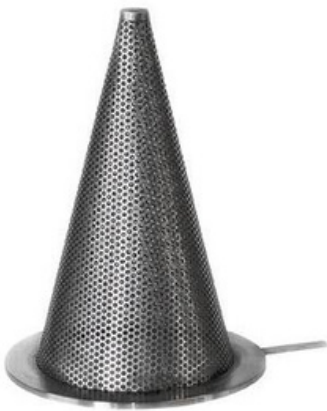

CONICAL STRAINERS

Temporary Conical Strainers

Design Features

- ▶ Standard sizes from 20 nb to 1200 nb
- ▶ Used primarily for new pipeline strat-up
- ▶ Filtration as fine as 40 microns available.
- ▶ Available in conical, basket and spectacle shapes
- ▶ May be installed in horizontal or vertical pipelines with cone pointed upstream or downstream.
- ▶ In to out and out to in design can be done.
- ▶ Spool piece can be supplied on request
- ▶ Guaranteed pressure drop as per Table 5a, 5b



Material Data

Ring	SS316/304, Duplex Steel
Handle	SS316/304, Duplex Steel
Perforated Sheet	SS316/304, Duplex Steel
Mesh	SS316/SS304

* Other materials available on request.

CONICAL TYPE

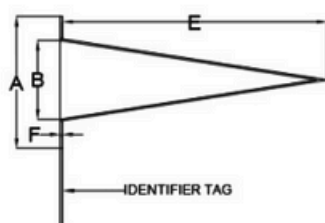

BASKET TYPE

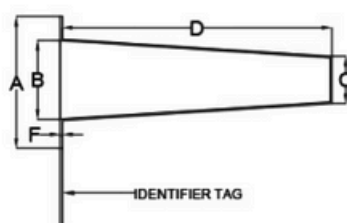
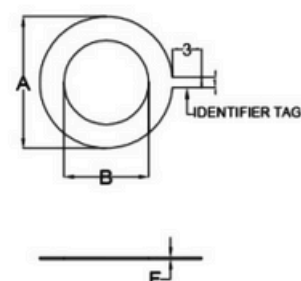

PLATE TYPE



Temporary Conical Strainers

Dimensions

Size mm	A (O.D) mm				B mm	C mm	D (Basket Length) mm				E (Cone Length) mm			
	150/300#	600#	900#	1500#			100%	150%	200%	300%	100%	150%	200%	300%
20	54	64	67	67	16	8	19	29	38	57	29	43	57	86
25	64	70	76	76	19	10	29	43	57	86	41	64	84	127
40	83	92	95	95	32	16	38	57	76	114	56	86	114	171
50	102	108	140	140	44	22	51	76	102	152	76	114	152	232
65	121	127	162	162	57	29	56	86	114	171	81	127	170	257
80	133	146	165	171	70	35	70	1.08	145	216	102	159	216	324
100	171	191	203	206	95	40	89	13.5	183	279	130	200	270	432
125	194	238	244	251	117	59	114	171	232	356	165	257	356	533
150	219	263	286	279	137	68	140	216	289	432	207	330	432	660
200	276	318	356	349	187	94	178	272	301	559	259	406	559	838
250	337	397	432	432	230	119	219	356	457	686	330	508	686	1016
300	406	454	495	517	279	140	267	432	559	838	406	610	838	1245
350	441	483	517	575	311	156	292	457	610	914	432	686	914	1372
400	511	555	572	638	356	178	356	533	711	1067	508	787	1041	1575
450	540	603	635	702	400	200	406	610	813	1194	584	889	1194	1803
500	597	676	695	753	445	222	432	686	889	1346	635	991	1346	2007
600	708	784	835	899	540	270	533	813	1067	162	762	1194	1600	2413



No.25/C,Parvathi Sankaran Premises,
Shankar sealing road, Ayanambakkam ,
Chennai 600095



sales.lksindustries@gmail.com

L K S



+91 8072051319
+91 91766 77207



www.lksindustries.com

SUCTION DIFFUSER

The Suction diffuser mounts to the suction side of a pump in either a horizontal or vertical position. It is designed to remove anything foreign matter that may be hazardous to the pump or other system components, while providing the proper flow conditions to the pump.

Where space is limited, the LKS suction diffuser can be used as an elbow

(in some cases a reducing elbow) with a built-in strainer easy maintenance and system performance

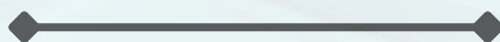



SUCTION DIFFUSERS

Suction Diffuser

Design Features

- ▶ Reduces installation costs by replacing the strainer, elbow, and entry pipe on the suction side of the pump
- ▶ Integral straightening vanes ensure uniform flow to the suction Inlet of the pump
- ▶ Minimal pressure drop (Oversized body & screen)
- ▶ Perforated stainless steel screen with a 20 mesh stainless steel. removable start-up sleeve to help promote a cleaner more trouble free system
- ▶ Bolted cover plate with O-ring seal - standard. (Knobs available upon request)
- ▶ Cast supporting pads on the diffuser body offer easy mounting of standard I.D. support foot
- ▶ Tapping for inlet and outlet differential connections - Optional
- ▶ Drain connection with plug - standard
- ▶ Magnetic strip on request



Material Data

BODY	CAST IRON, CAST STEEL, SS304, SS316, FABRICATED CS
SCREEN	STAINLESS STEEL (SS304, SS316), BRASS
MESH SLEEVE	STAINLESS STEEL (SS304, SS316), BRASS
COVER	CAST IRON, CAST STEEL, SS304, SS316, FABRICATED CS
GASKETS	CAF, NEOPRENE
HEX HEAD BOLT †	STEEL
PLUG	CAST CARBON STEEL
STUB	SAME AS BODY

* Ductile Iron Knobs are available upon request.

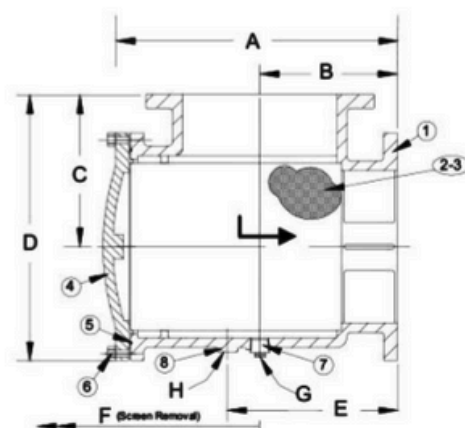

Applications

The Flometriq Suction diffuser mounts to the suction side of a pump in either a horizontal or vertical position. It is designed to remove any foreign matter that may be hazardous to the pump or other system components, while providing the proper flow conditions to the pump. Where space is limited, the Flometriq suction diffuser can be used as an elbow (in some cases a reducing elbow) with a built in strainer easy maintenance and system performance.

Construction

The Flometriq Suction Diffusers are constructed from rugged cast iron castings that are machined to exacting specifications. These bodies have drilled flanges that are in accordance with ASME B16.1.

Suction Diffuser

Screen Sizes

SIZE	SCREEN PERFORATION	OPEN AREA
2" to 12"	3/16"	51%

* 20 mesh stainless steel sleeves are provided with all Suction Diffusers for start up applications.

Working Pressures - Non Shock

NOM. RATING	MEDIA	2" to 12"	14" and Larger
125# (FLANGED)	W.O.G.	200 PSI @ 150 °F	150 PSI @ 150 °F

Dimensions

Size (Inlet X Outlet)	A	B	C	D	E	F (Screen Removal)	G (Blow Down Connection)	H (Pipe Support I.D)	Weight (Lbs)
2 X 1-1/2	10	4-1/2	4-1/2	7	6	8-13/16	3/4	1.02	24
2 X 2	10	4-1/2	4-1/2	7	6	8-13/16	3/4	1.02	24
2-1/2 X 2	10-5/8	5	5	7-13/16	6-9/16	9-1/8	3/4	1.02	27
2-1/2 X 2-1/2	10-5/8	5	5	7-13/16	6-9/16	9-1/8	3/4	1.02	37
3 X 2	10	4-1/2	5-1/2	8-1/8	6	9-5/8	3/4	1.30	42
3 X 2-1/2	11-3/16	5-1/2	5-1/2	9	7	9-5/8	3/4	1.30	46
3 X 3	11-3/16	5-1/2	5-1/2	9	7	9-5/8	3/4	1.30	51
4 X 3	13-1/8	6-1/2	6-1/2	11	8-3/4	11-1/2	1	1.30	74
4 X 4	13	6-1/2	6-1/2	11	8-1/4	11-1/2	1	1.30	76
5 X 4	15-1/2	7-1/2	7-1/2	13	10	14-7/8	1	1.30	106
5 X 5	15-1/2	7-1/2	7-1/2	13-3/4	10	14-7/8	1	1.30	111
6 X 4	13-1/8	6-1/2	8	12-3/16	8-3/4	16-9/16	1	1.30	93
6 X 5	16-5/8	8	8	14-7/16	10-11/16	16-9/16	1	1.30	128
6 X 6	16-5/8	8	8	14-1/2	10-11/16	16-9/16	1	1.30	149
8 X 5	19-3/16	9	7-9/16	13-1/8	13	16-7/8	1	1.30	178
8 X 6	16-7/8	8	9	15-1/2	10-11/16	16-7/8	1	1.30	178
8 X 8	21-3/8	9	9	17-1/4	11-5/8	22-7/8	1-1/4	2.05	267
10 X 8	21-3/16	9	11	19-1/4	11-5/8	22-7/8	1-1/4	2.05	353
10 X 10	26-11/16	11	11	20-3/4	14-3/16	30-1/4	1-1/4	2.05	388
12 X 8	21-11/16	11	11	19-1/4	13-5/8	22-7/8	1-1/4	2.05	492
12 X 10	26-11/16	11	12	21-3/4	14-3/16	33	1-1/4	2.05	492
12 X 12	26-11/16	12	12	21-3/4	15-3/8	28-3/4	1-1/4	2.05	529

* Larger sizes available on request

Certified dimensional drawings and metric drawings available upon request.



No.25/C,Parvathi Sankaran Premises,
Shankar sealing road, Ayanambakkam,
Chennai 600095



sales.lksindustries@gmail.com



+91 8072051319
+91 91766 77207



www.lksindustries.com

FABRICATED SUCTION DIFFUSER

SD-FA Series

Design Specifications

- Standard sizes from 10"X6" up to 24"X24"
- Designed for direct mounting to the suction side of a pump in either horizontal or vertical positions.
- Integral straightening vanes reduce flow turbulence.
- Strainers are complete with RF flanges in accordance with ASME B16.5
- Available with equal or reduced outlet flanges Welded on supporting pads for convenient mounting of standard I.D. support foot.
- All welders are qualified to ASME section IX
- Diffusers designed to meet the requirements of ASME B31.1, ASME B31.3 and/or ASME section VIII, DIV.I.
- Drain connection furnished with plug as standard
- Differential connections are optional

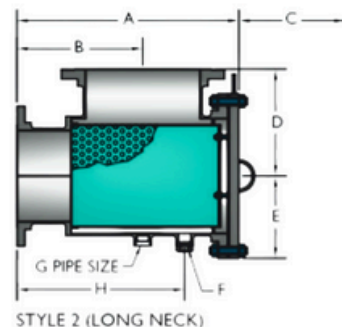
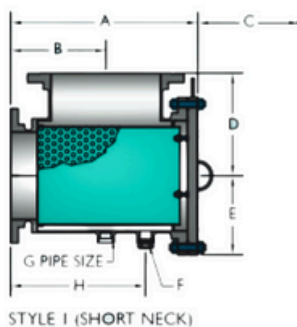

Parts List and Standard Materials

DESCRIPTION	SPECIFICATION	
	CARBON STEEL	STAINLESS STEEL
Shell	A53 E/B/A 106-B	A312
Nozzles	A53 E/B/A 106-B	A312
Flanges	A105	A182
Heads	A5 16-70	A240
Coupling	A105	A182
Plug	A105	A182
Basket	304 SS	304 SS
Gasket	304 SS Spiral Wound	304 SS Spiral Wound
Stud	A193-B7	A193-B8-I
Nut	A194-2H	A194-B

SIZE in/mm		A in/mm		B in/mm		C in/mm (I)		D in/mm	E in/mm	F in/mm	G in/mm	H in/mm		Weight Lb./Kg.
INLET	OUTLET	STYLE 1 (I)	STYLE 2	STYLE 1 (I)	STYLE 2							STYLE 1	STYLE 2	
10	6	19.75	24.63	9.75	14.25	16.38	12.63	8.00	1	1	13.75	17.75	261	
250	150	502	626	248	362	416	321	203	25	25	349	451	118	
10	8	20.38	24.63	10.00	14.25	16.75	12.63	9.50	1	1	14.13	18.38	339	
250	200	518	626	254	362	425	321	241	25	25	359	467	154	
10	10	20.75	25.50	10.13	14.88	17.00	13.63	10.50	1	1	14.38	19.13	420	
250	250	527	648	257	378	432	346	267	25	25	365	486	191	
12	8	22.38	27.88	11.0	15.25	18.75	12.88	9.50	1-1/2	1-1/2	15.63	19.88	437	
300	200	568	708	279	387	476	327	241	40	40	397	505	198	
12	10	22.75	27.50	11.25	16.00	18.88	13.88	10.50	1-1/2	1-1/2	16.00	20.75	530	
300	250	578	699	286	406	479	353	267	40	40	406	527	240	
12	12	23.38	28.13	11.50	16.25	19.25	15.13	11.75	1-1/2	1-1/2	16.38	21.13	650	
300	300	594	714	292	413	489	384	298	40	40	416	537	295	
14	10	24.00	28.75	11.88	16.63	20.13	14.00	10.50	1-1/2	1-1/2	16.88	21.63	670	
350	250	610	730	302	422	511	356	267	40	40	429	549	304	
14	12	24.63	31.13	12.13	18.38	20.50	16.00	11.75	1-1/2	1-1/2	17.38	22.13	808	
350	300	626	791	308	467	521	406	298	40	40	441	562	367	
14	14	25.00	31.13	12.25	18.38	20.75	16.00	12.50	1-1/2	1-1/2	17.63	22.88	964	
350	350	635	791	311	467	527	406	318	40	40	448	581	437	
16	12	27.50	31.75	14.00	18.00	22.50	16.50	11.75	2	2	19.00	23.75	913	
400	300	699	806	356	457	572	419	298	50	50	483	603	414	
16	14	27.00	32.25	13.25	18.50	22.75	16.25	12.50	2	2	19.13	24.38	1089	
400	350	686	819	337	470	578	413	318	50	50	486	619	493	
16	16	27.75	33.13	13.75	19.00	23.13	17.50	13.75	2	2	19.50	25.00	1280	
400	400	706	842	349	483	588	445	349	50	50	495	635	581	
18	14	28.50	35.38	14.00	19.58	23.00	17.63	12.50	2	2	20.25	26.00	1058	
450	350	724	898	356	498	584	448	318	50	50	514	660	480	
18	16	30.00	35.25	14.88	20.13	25.13	17.63	13.75	2	2	21.13	26.63	1256	
450	400	762	895	378	511	638	448	349	50	50	537	676	569	
18	18	30.38	36.38	14.75	20.75	25.63	19.88	16.00	2	2	21.50	27.50	1572	
450	450	772	924	375	527	651	505	406	50	50	546	699	713	
20	16	32.25	37.25	15.63	21.13	27.13	20.13	13.75	2	2	22.63	28.13	1452	
500	400	819	946	397	537	689	511	349	50	50	575	715	659	
20	18	32.50	38.50	15.88	21.88	27.63	20.13	16.00	2	2	23.13	29.13	1793	
500	450	826	978	403	556	702	511	406	50	50	588	740	813	
20	20	35.88	42.13	16.0	22.25	30.88	23.50	19.38	2	2	24.88	31.13	2560	
500	500	911	1070	406	565	784	597	492	50	50	632	791	1161	
24	18	36.63	42.63	18.00	24.00	31.63	20.50	16.00	2	2	26.25	32.25	2382	
600	450	930	1083	457	610	803	521	406	50	50	667	819	1080	
24	20	40.00	46.25	18.13	24.38	34.88	23.88	19.38	2	2	28.00	34.25	3545	
600	500	1016	1175	461	619	886	607	492	50	50	711	870	1608	
24	24	40.38	47.38	18.50	25.50	34.88	23.88	19.38	2	2	28.38	35.38	3600	
600	600	1026	1203	470	648	886	607	492	50	50	721	899	1633	



No.25/C,Parvathi Sankaran Premises,
Shankar sealing road, Ayanambakkam,
Chennai 600095



sales.lksindustries@gmail.com

L K S



+91 8072051319
+91 91766 77207



www.lksindustries.com

DUPLEX STRAINER

Duplex strainer or twin basket strainer is a type of filter built into a fuel, oil or water piping system and it is used to remove large particles of dirt and debris. The duplex strainer system usually consists of two separate strainer baskets housings. The system also contains a valve handle placed between the two baskets to divert the flow of liquid to one strainer while the other is being cleaned. On some strainers, the valve will work automatically and the strainer will perform a self-cleaning operation.

These types of strainers are installed in pipeline systems where flow cannot be stopped. Depending upon their NB size they are capable of filtration up to 40 μm . Basket Strainers find use in industries where impurities are mostly solids. Unlike other types of strainers, it is easy to conduct maintenance on these strainers.

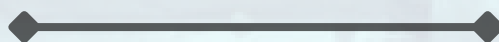

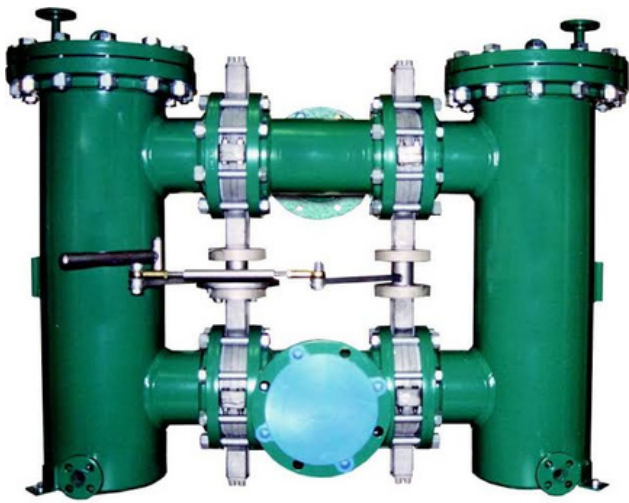

DUPLEX STRAINERS

FABRICATED DUPLEX STRAINERS - 150/300 lbs

DP-Series-Style Butterfly-In Line 150/300 lbs

Design Features

- ▶ Standard sizes from 125 nb to 300 nb
- ▶ Available In flanged Ends To ANSI B16.5 , AWWA , IS Standards with 150/300 ratings
- ▶ Butterfly type diverter valves
- ▶ Standard thru bolt cover design. Other covers on request
- ▶ Perforated screens are standard
- ▶ May be installed in horizontal pipelines
- ▶ All welders are qualified to ASME Section IX
- ▶ Strainers designed to meet the requirements of ASME Section VIII, Div.1
- ▶ Drain with plug is standard . Drain valves can be supplied on request
- ▶ Vents with plug and Dp indicators are standard
- ▶ Large body with Guaranteed low pressure drop as per Appendix 3 in engineering data
- ▶ Net free straining area minimum 6 times for standard screen

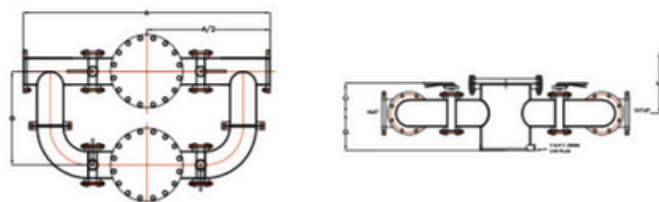

Material Data

COMPONENT	MATERIALS
Body	IS1239,3589 ASTM A106, SS304/316, DUPLEX STEEL
Cover	A105, SA 516 GR 70, CS TO IS 2062, SS316,304, DUPLEX STEEL
Valve Body	Cast Iron, ASTM A 216 WCB,CF8,CF8M
Valve Disc	CI,SS 304, SS 316
Fastener	A193 B7 Bolts & A 194 2 H Nuts with spring washer. SS 304/316
Gaskets	CAF, NACF, Neoprene, Nitrile,PTFE
Valve Seat	EPDM,Nitrile,PTFE
Drain / Vent Plug	A105, CS TO IS 1875-II, Stainless Steel
Filter Element	SS 304,316, Duplex, Brass, Monel, Hastalloy C

* Other materials available on request.

Standard Screens

SIZE RANGE	OPENING	GUAGE THICKNESS
5"-8"(125mm-200mm)	0.125 IN. (3.2mm)	0.8mm
10"-12"(250mm-300mm)	0.125 IN. (3.2mm)	1.5mm

Dimensions

Size	A	B	C	D	E	F NPT
125	1230	384	168	680	798	25
150	1295	410	178	806	934	25
200	1549	461	235	1058	1243	40
250	1759	562	273	1350	1533	40
300	2013	613	340	1581	1851	50



No.25/C,Parvathi Sankaran Premises,
Shankar sealing road, Ayanambakkam ,
Chennai 600095



sales.lksindustries@gmail.com

L K S



+91 8072051319
+91 91766 77207



www.lksindustries.com

FABRICATED DUPLEX STRAINERS - 150/300 lbs

DP-Series-Style Butterfly in Line Column

Design Features

- ▶ Standard sizes from 50 nb to 1200 nb
- ▶ Available In flanged Ends To ANSI B16.5 , AWWA , IS Standards with 150/300 ratings
- ▶ Butterfly type diverter valves
- ▶ Standard thru bolt cover design. Other covers on request
- ▶ Perforated screens are standard
- ▶ May be installed in horizontal pipelines
- ▶ All welders are qualified to ASME Section IX
- ▶ Strainers designed to meet the requirements of ASME Section VIII, Div.1
- ▶ Drain with plug is standard . Drain valves can be supplied on request
- ▶ Vents with plug and Dp indicators are standard
- ▶ Large body with Guaranteed low pressure drop as per Appendix 3 in engineering data
- ▶ Net free straining area minimum 6 times for standard screen

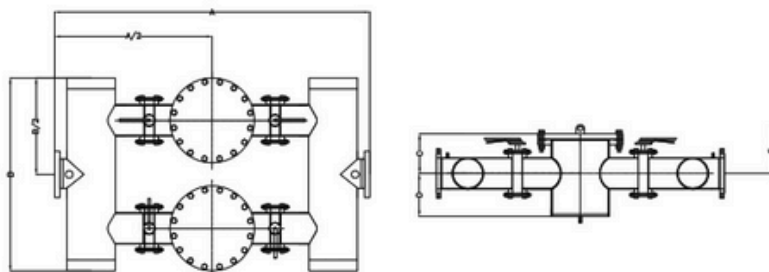

Material Data

COMPONENT	MATERIALS
Body	IS1239,3589 ASTM A106, SS304/316, DUPLEX STEEL
Cover	A105, SA 516 GR 70, CS TO IS 2062, SS316,304, DUPLEX STEEL
Valve Body	Cast Iron, ASTM A 216 WCB,CF8,CF8M
Valve Disc	Cast Iron,SS 304, SS 316
Fastener	A193 B7 Bolts & A 194 2 H Nuts with spring washer SS 304/316
Gaskets	CAF, NACF, Neoprene, Nitrile,PTFE
Valve Seat	EPDM,Nitrile rubber,PTFE
Drain / Vent Plug	A105, CS TO IS 1875-II, Stainless Steel
Filter Element	SS 304,316, Duplex, Brass, Monel, Hastalloy C

* Other materials available on request.

Standard Screens

SIZE RANGE	OPENING	GUAGE THICKNESS
2"-8"(50mm-200mm)	0.125 IN. (3.2mm)	22
10"-12"(250mm-300mm)	0.125 IN. (3.2mm)	16
14"-24"(250mm-600mm)	0.188 in. (4.8mm)	11

Dimensions

Size	A	B	C	D	E
50	813	508	152	302	404
80	965	610	203	453	606
100	965	660	203	554	707
150	1219	914	254	806	1010
200	1448	1092	305	1058	1313
250	1930	1397	330	1310	1590
300	2159	1448	356	1561	1867
350	2337	1524	457	1813	2220
400	2642	1626	508	2065	2533
450	2946	2083	508	2317	2775
500	30.48	2210	610	2569	3129
600	3353	2388	711	3072	3733



No.25/C,Parvathi Sankaran Premises,
Shankar sealing road, Ayanambakkam ,
Chennai 600095



sales.lksindustries@gmail.com

L K S



+91 8072051319
+91 91766 77207



www.lksindustries.com

FABRICATED DUPLEX STRAINERS - 150/300 lbs

DP P Series BFV OL Series

Design Features

- ▶ Standard sizes from 50 nb to 1200 nb
- ▶ Available In flanged Ends To ANSI B16.5 , AWWA , IS Standards with 150/300 ratings
- ▶ Butterfly type diverter valves
- ▶ Standard thru boltcover design. Other covers on request
- ▶ Perforated screens are standard.
- ▶ May be installed in horizontal pipelines
- ▶ All welders are qualified to ASME Section IX.
- ▶ Strainers designed to meet the requirements of ASME Section VIII,Div.1.
- ▶ Drain with plug is standard . Drain valves can be supplied on request
- ▶ Vents with plug and Dp indicators are standard
- ▶ Large body with Guaranteed low pressure drop as per pressure drop curves in Table - 4
- ▶ Net free straining area minimum 6 times for standard screen

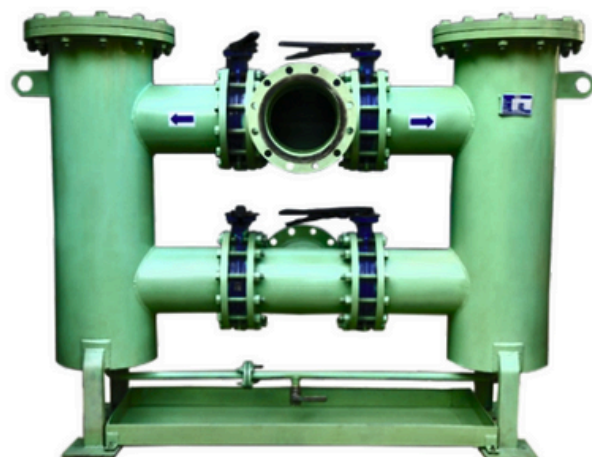

Material Data

COMPONENT	MATERIAL
Body	IS1239,3589 ASTM A106, SS304/316, DUPLEX STEEL
Cover	A105, SA 516 GR 70, CS TO IS 2062, SS316,304, DUPLEX STEEL
Valve Body	Cast Iron, ASTM A 216 WCB,CF8,CF8M
Valve Disc	Cast Iron,SS 304, SS 316
Fastener	A193 B7 Bolts & A 194 2 H Nuts With spring washer. SS 304/316
Gasket	CAF, NACF, Neoprene, Nitrile,PTFE
Drain/Vent Plug	A105, CS TO IS 1875-II, Stainless Steel
Filter Element	SS 304,316, Duplex, Brass, Monel, Hastalloy C

Standard Screens

SIZE RANGE	OPENING
5"-8"(125mm-200mm)	0.125 IN. (3.2mm)
10"-12" (250mm-300mm)	0.125 IN. (3.2mm)
14"-24" (350mm-600mm)	0.188 IN. (4.8mm)

FABRICATED DUPLEX STRAINERS - 150/300 lbs

DP P Series BFV OL Series

Dimensions

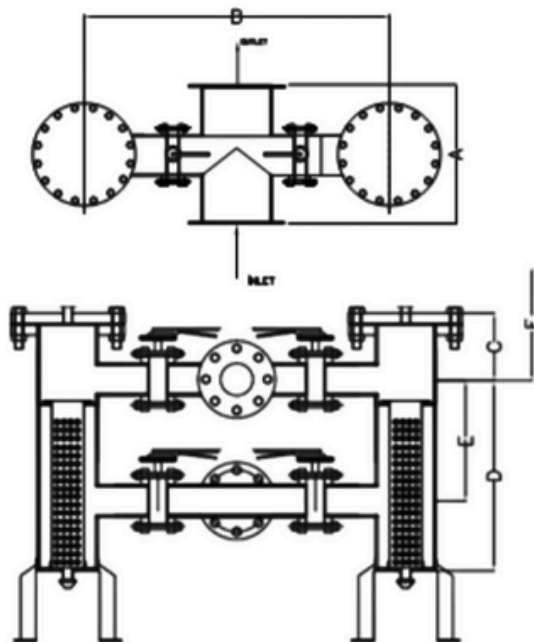

Size	A	B	C	D	E	F NPT	Weight(ib/kg)
50	254	660	165	508	356	813	280/127
80	311	762	194	572	388	978	300/136
100	362	914	213	648	445	1054	450/204
150	464	1118	284	881	568	1295	700/318
200	559	1270	366	1158	732	1499	1400/636
250	635	1626	441	1435	883	1701	1850/840
300	737	1829	517	1711	1034	2028	2750/1249
350	816	1930	611	1988	1223	2374	4000/1816
400	864	2134	693	2265	1387	2708	5300/2406
450	965	2388	763	2542	1525	3030	5900/2679
500	1051	2642	857	2819	1715	3376	8000/3632
600	1168	3099	1021	3372	2042	4043	9000/4086

SELF CLEANING STRAINER

Self-cleaning filters or self-cleaning strainers are innovative and efficient filtration systems that utilize their own system pressure to clean the clogged particles or dirt after a period of time. Self-cleaning filters/strainers allow clean fluid to flow through the system while removing particles or dirt.

Typical self-cleaning filtration systems include a fine screener, coarse screener, particle remover, piston, flush valves, differential pressure gauge, and a controller.

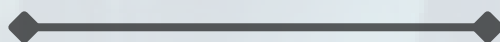



SELF-CLEANING STRAINERS

The background of the page features a close-up, slightly blurred image of industrial sight glass components. These components include dark, cylindrical metal housings with a central horizontal glass tube. The scene is set against a light blue background with some faint, out-of-focus lines, suggesting an industrial or laboratory environment.

SIGHT GLASS

Sight glasses have been in use in the industry for a long time. One of the earliest applications for these instruments was as water level gauges in the boilers of steam-powered locomotive engines, where they were used to ensure that water was kept at a specified level to maintain safe operations. For low-pressure, non-critical applications in which the fluid or media being observed is both low in temperature and non-abrasive, sight glass windows may be made from standard soda lime glass. This type of glass, though, will crack at higher temperatures, so for process fluids up to 536°F, borosilicate glass or acrylic plastics are the standard materials used to construct sight glass windows. Above 536°F, sight glass windows are constructed from quartz or sapphire glass.

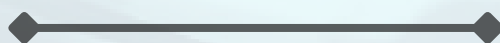



SIGHT GLASS

BALL VALVE

A ball valve is a shut-off valve that allows, obstructs, and controls the flow of liquids, gases, and vapours in a piping system by rotating the ball having a bore inside the valve. The ball is mounted against two seats and has a shaft that connects it to the operating and control mechanism that rotates the ball. When the cross-section of the bore is perpendicular to the area of the flow, the fluid is not permitted to pass through the valve.

The fluid flows through from the valve, and the fluid flow rate depends on the area of the bore exposed to the flow.

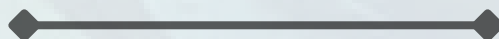



LEVER OPERATION



PNEUMATIC OPERATION



GEAR + PNEUMATIC OPERATION



BALL VALVES

GATE VALVE

Gate valve is a control valve that either allows media to flow through unobstructed or stops the fluid flow.

The main advantage of a gate valve is the straight-through unobstructed passageway, which induces minimal pressure loss over the valve.

The unobstructed bore of a gate valve also allows for a pig's passage in cleaning pipe procedures, unlike butterfly valves. However, gate valves are slower than quarter-turn valves and should only be used in the fully open or closed position, not to regulate the flow.

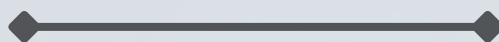



HANDWHEEL OPERATION



MOTORIZED OPERATION



GERA OPERATION



GATE VALVES

KE - GATE VALVE

Knife gate valves are designed mainly for on-off and isolation services in systems with high content of suspended solids.

Knife gate valves are especially beneficial for handling slurry in addition to viscous, corrosive and abrasive media. The valves have a minimised pressure drop in fully open position, they are easy to actuate, they have a relatively low weight and are cost-effective. Knife gate valves are designed to work in some of the harshest environments, typically having a sharpened blade to cut through heavy liquids. They are especially useful in wastewater applications where corrosion is an important issue.

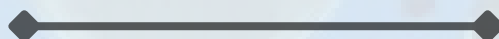



HANDWHEEL OPERATION



PNEUMATIC OPERATION



GEAR OPERATION



MOTORIZED OPERATION

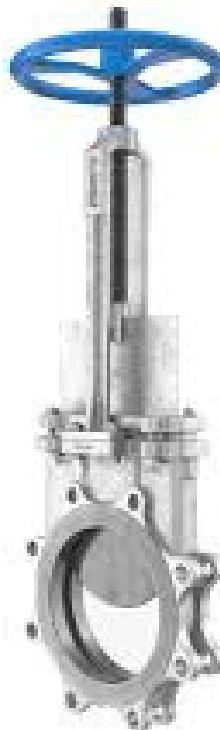

KNIFE EDGE GATE VALVES

GLOBE VALVE

A globe valve is an instrument used to stop and/or control the flow of fluids in a pipeline. It works by halting the flow of a fluid through a pipe. The name globe comes about due to the valve's cylindrical shape. There are usually two halves of the body within the globe valve that are separated by an internal baffle. Even though globe valves exhibit more pressure drops than gate valves, you can use them where the pressure drop via the valve is a non-controlling factor. Another name for globe valves is throttle valves when they are used for throttling purposes.

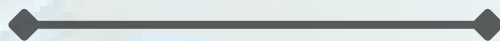



GLOBE VALVES

NRV/CHECK VALVE

A non-return valve, also known as a check valve, clack valve, one-way valve or retention valve, is designed to allow fluid to flow in one direction only, therefore preventing the liquid or gas from flowing back upstream of the valve. In this guide, we take a look at how a non-return valve operates, and what a non-return valve is used for, including some of the applications in which you might find one. A non-return valve's functions include preventing reverse flow, protecting equipment, ensuring system efficiency, avoiding mixing or contamination, and enhancing safety. It is essential for maintaining desired flow direction, preventing damage, and maintaining system integrity.

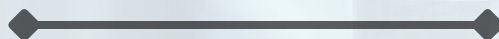



NRV/CHECK VALVES

BUTTERFLY VALVE

Butterfly valves are a family of quarter-turn rotational motion valves that are used in pipelines to shut-off. A couple of their key advantages over other valve families are their simple construction and compactness, resulting in the end products being of lighter weights and lower cost and with smaller installation footprints and faster actuation speeds. Butterfly valves are flanged double eccentric type (double offset) type. The double offset or eccentricity refers to the fact that this valve design involves two offsets of the disc from the valve body's centre or the axis of rotation of the stem.

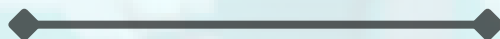



LEVEL OPERATION



GEAR OPERATION



PNEUMATIC OPERATION



BUTTERFLY VALVES

SLIDE GATE VALVE

Slide gate valves are designed to provide an efficient method for controlling the flow of free-flowing dry bulk materials.

Although there are some major differences, slide gate valves are also known as knife gate valves.

These type of gate valves are generally installed at the outlet of dry bulk storage bins, silos, hoppers, chutes, mechanical conveyors or any similar gravity discharge points.

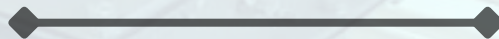

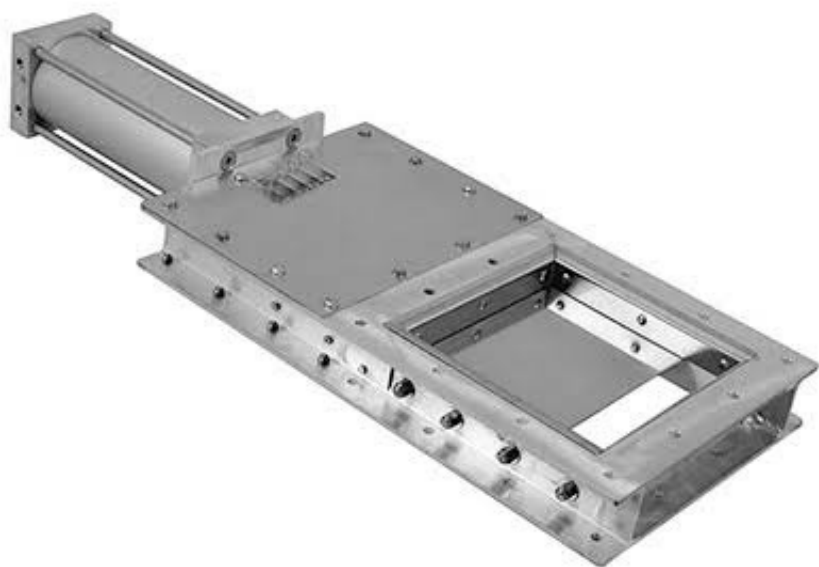
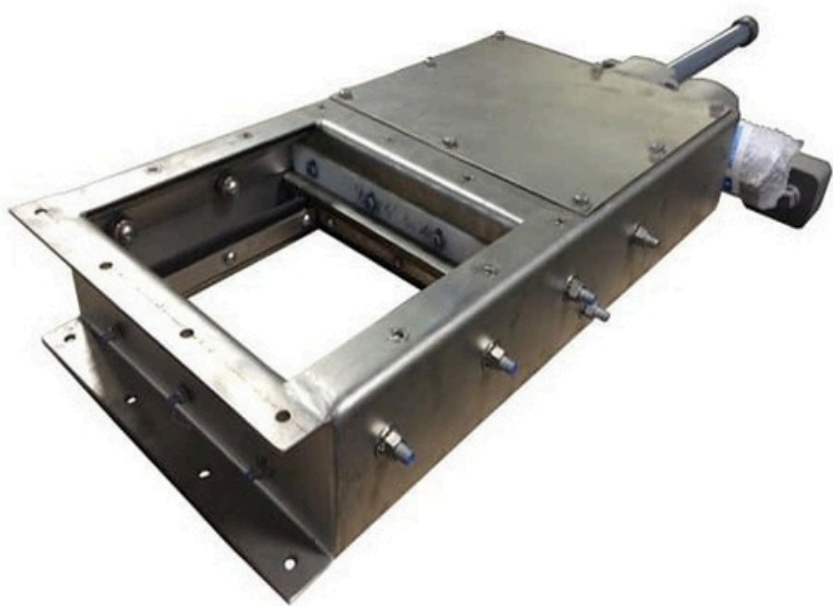
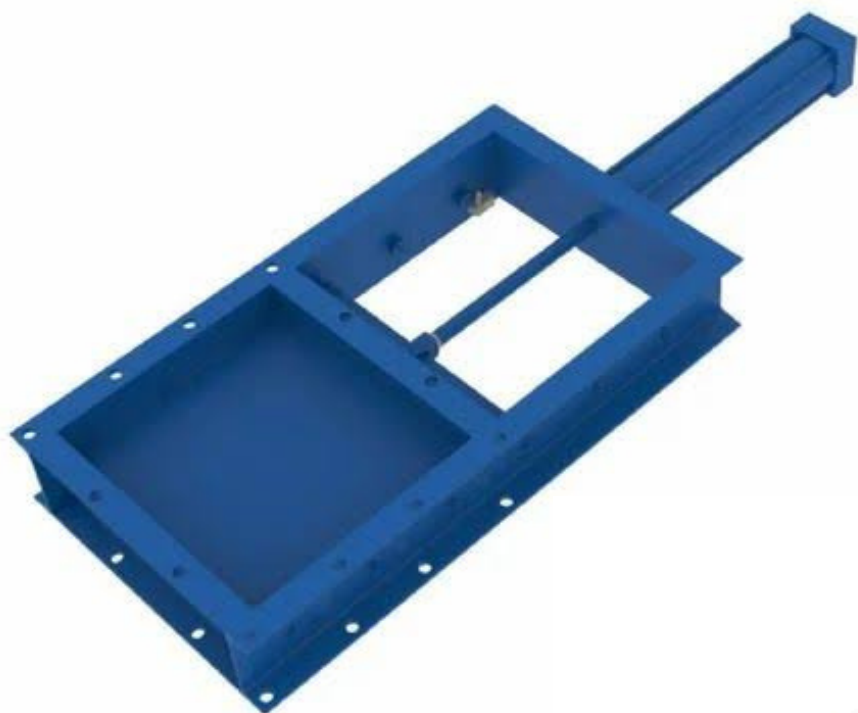

SLIDE GATE
VALVES

DIAPHRAGM VALVE

A diaphragm valve, or membrane valve, is a valve with an elastomeric diaphragm and a seat upon which the diaphragm rests when it is closed. The flexible diaphragm obstructs, controls, or isolates the flow of fluids and acts as a flow control device. In a diaphragm valve, the diaphragm element flexes up or down to increase or decrease the fluid flow rate. The valve is sealed when the diaphragm is pressed firmly against its solid seat. Diaphragm valves are linear motion valves that monitor and control linear movement of fluids.





DIAPHRAGM
VALVES

AIR RELEASE VALVE

Air Eliminators improve the circulation of pressurised liquids by eliminating air and other non-condensable gases, which may collect at high points in the system. An air eliminator is a segment of piping which attaches to a main pipe to trap and release air, fitted ahead of flow meters in a pipeline so that air will not be measured and a more accurate volumetric reading can therefore be taken.

